





Instructions for activation of Commissioning Flush Bluewater Pro.

proceed with steps 1-12 as follows:

-  A Commissioning flush **MUST** be performed when the water purifier is first installed and whenever a reverse osmosis membrane is replaced.
-  This **VERY IMPORTANT** 54 minute Commissioning flush must be allowed to continue to completion.
-  **DO NOT** interrupt this flush.
-  **DO NOT DRINK** the water until this flush is completed.
-  Pro **MUST NOT** be connected to any drinking water storage tank, appliance, or equipment at this time. All drinking water equipment must be disconnected, except a faucet or shutoff valve, until the Commissioning flush is completed.

1

Start with Pro disconnected from electrical power. Read through steps, 2-12 before beginning.

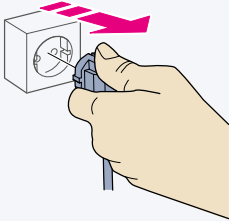

2

Turn on the purified water faucet.

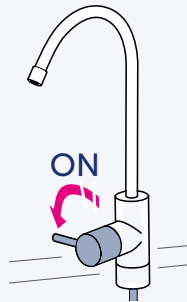

3

Turn on the inlet supply water.

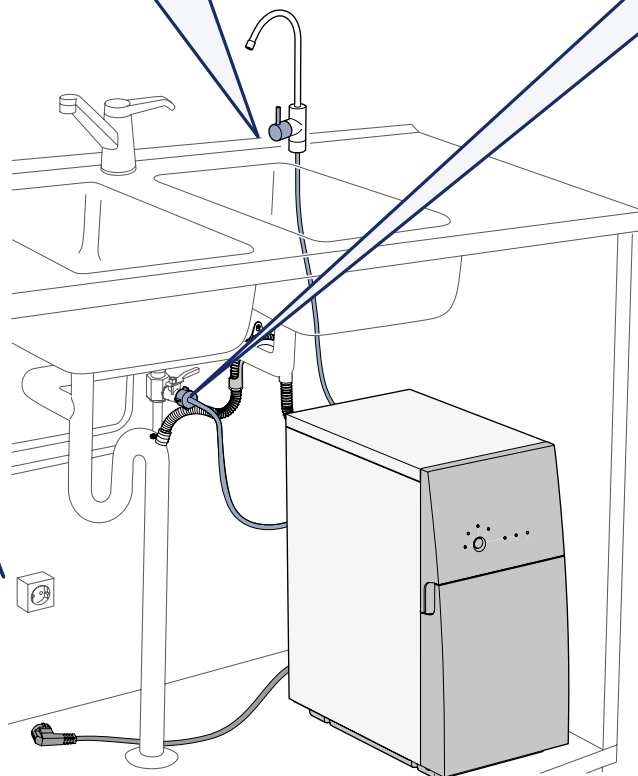
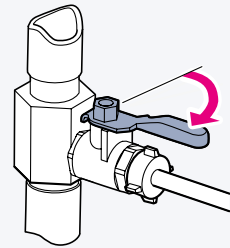

4

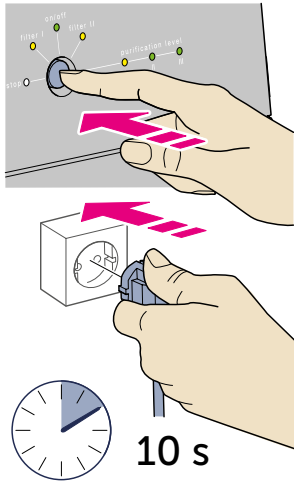

Press and hold the Control panel Button while plugging Pro into an electrical outlet. Keep the Button pressed for about 10 seconds.

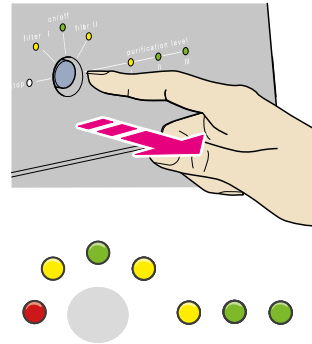

Release the Button when all lights are on.

5

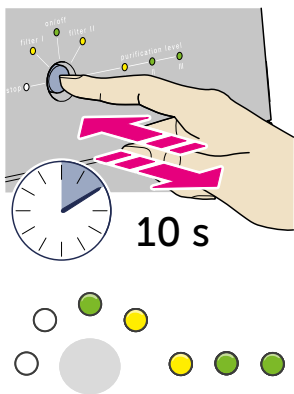

Again, press and hold the Control panel Button for 10 seconds.

Release the Button when these lights appear.

6

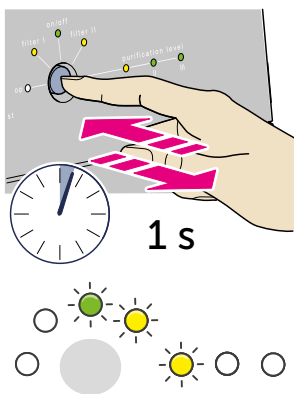

Press and hold the Control panel Button for 1 second.

Release the Button when these flashing lights appear.

7

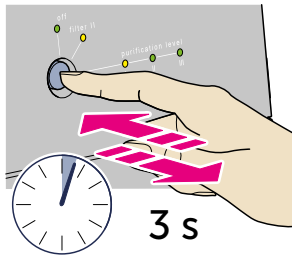

Press and hold the Control panel Button for 3 seconds.

Release the Button when these lights appear.



8

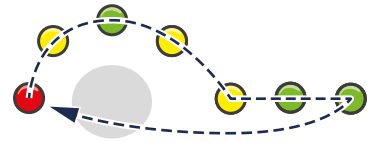
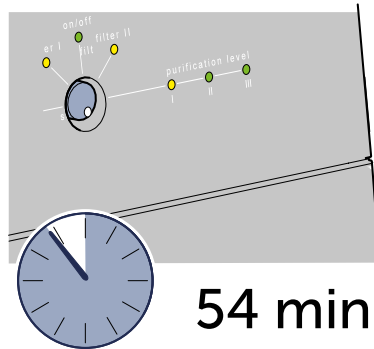
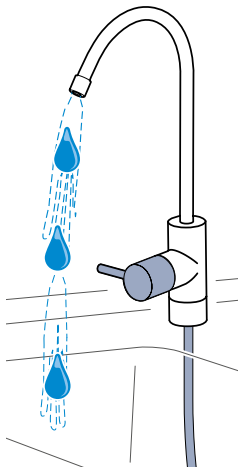

Commissioning Flush is now activated. Water will cycle on and off for 54 minutes.

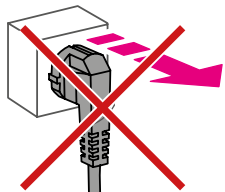

DO NOT DRINK!
DO NOT UNPLUG!



Check hose and tubing connections for leaks. See "Do a check for leaks". In case of a leak or if Pro must be left unattended, stop the flush and follow the EMERGENCY STOP procedure and restart procedure below.

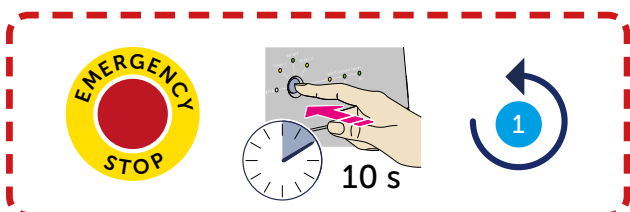

For emergency stop press calibration button for 10 sec and go back to 14a to restart Commissioning Flush.

9

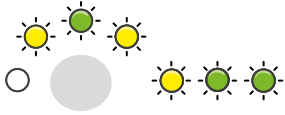
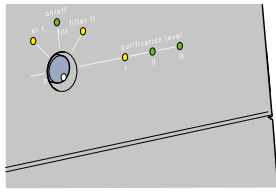

After the 54 minute flush, this light sequence appears.

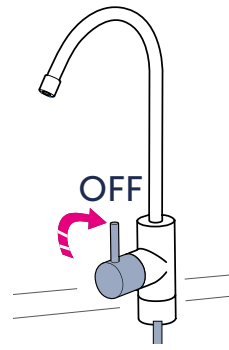

When these flashing lights appear, turn off the faucet.

10

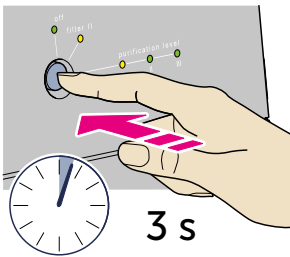

Press and hold the Control panel Button for 3 seconds.

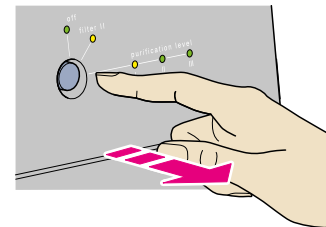
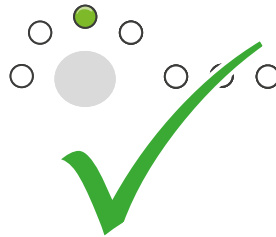

Release the Button when the ON light appears. Flushing is complete.

11

Drinking water equipment such as reverse osmosis approved storage tanks and appliances can now be connected to the purified water tubing.

12

Do a check for leaks



The hose connections must be tight! Check All hose, tubing, valve, faucet, and drinking water equipment connections.

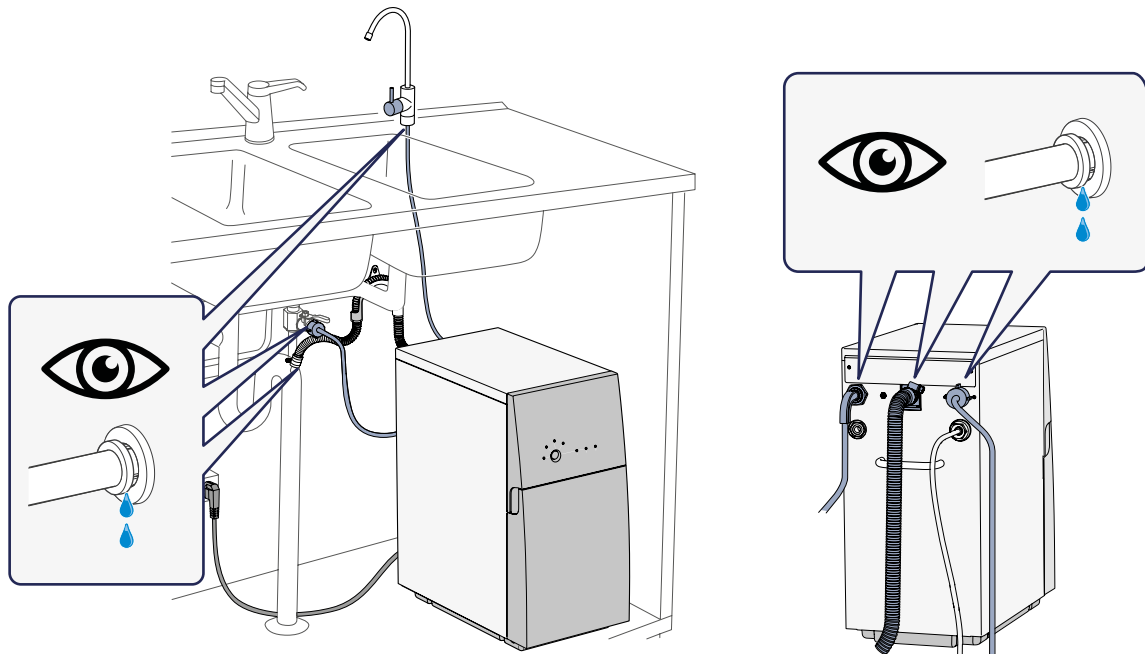

Enjoy your **BLUEWATER PRO!**
One of the best water purifiers in the world!